

TRADESHOW MANUAL 2020



The FUTURE of waste collection, TODAY

OWMA
PROUD
OWMA
MEMBER

REVOLUTIONIZING
Waste and Recycling Collection
MOLOK

MOLOK
by Veikko Salli

MOLOK
REVOLUTIONIZING
Waste and Recycling Collection

Deep Collection™
for
waste
recyclables
organics
cooking oil

The FUTURE of waste collection, TODAY

MOLOK
North America Ltd.

TABLE OF CONTENTS

Booth Layouts & Configurations	3
Booth Components - Peripherals	4
Booth Components: Samples	5
Booth Components: Floor Models	6
Assembly Instructions: Halo	7
Assembly Instructions: 8x8 Display	8
Assembly Instructions: Video	9
Assembly Instructions: 4x6	10
Assembly Instructions: Counter	11
Assembly Instructions: Pullup	12
Assembly Instructions: POPUP	13
Marketing Materials - Brochures	14
Marketing Materials - Giveaways	15



BOOTH LAYOUTS & CONFIGURATIONS

10X10 BOOTH - 3 wall

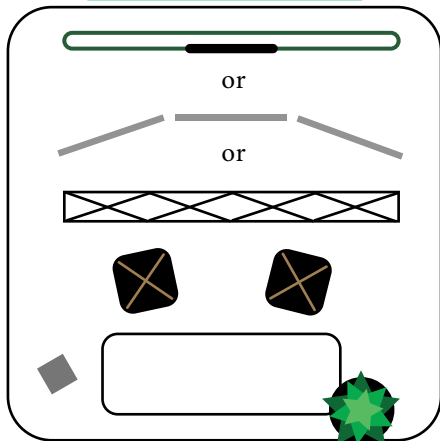

10X20 BOOTH - 2 wall

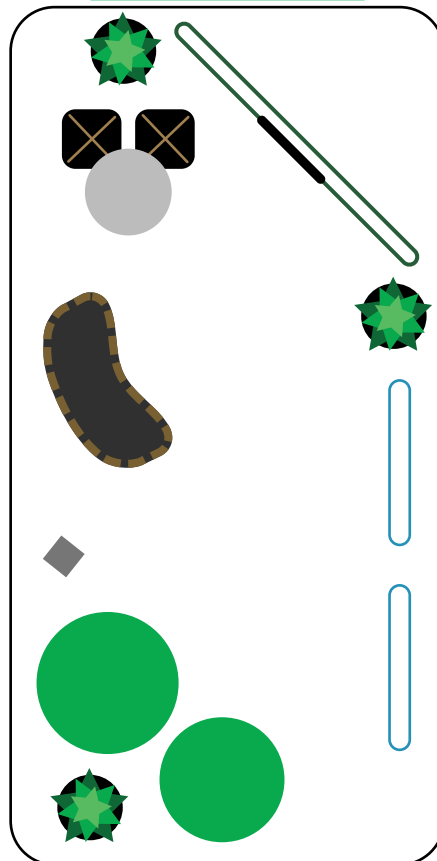

LEGEND

POP-UP



PULL-UPS



COUNTER



8X8 WITH MONITOR



4X6 STANDS



6' TABLE

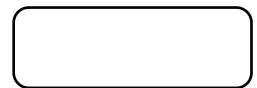

HIGH CHAIRS



CUTOFF MODELS



BROCHURE STAND



BAR TABLE



PLANTS



10X10 BOOTH - 2 wall, corner

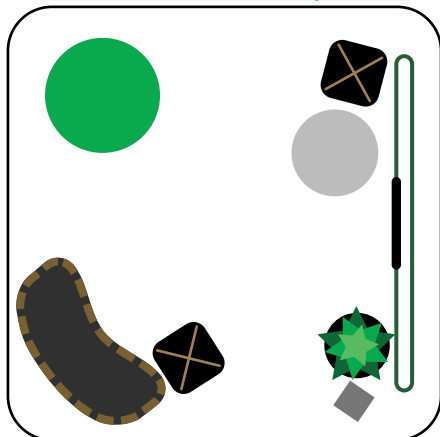

10X10 BOOTH - open concept

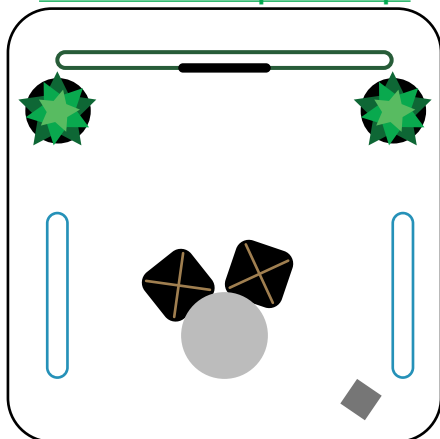

10X20 BOOTH - 3 wall or back wall only

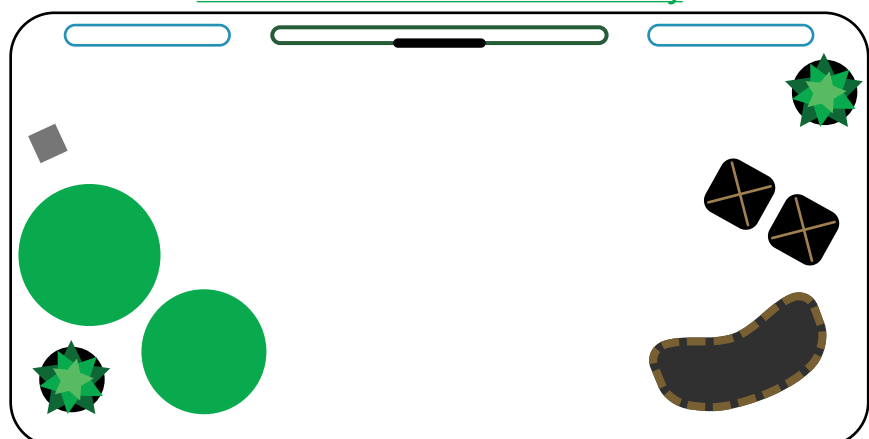

BOOTH COMPONENTS - PERIPHERALS



BROCHURE STAND



PLINKO GAME



BAR-HEIGHT CHAIRS



BRANDED TABLE SKIRT

BOOTH COMPONENTS: SAMPLES

M-300 CUT OUT SAMPLE



VAN GOGH WRAP SAMPLE



TEXTILE LID SAMPLE

BOOTH COMPONENTS: FLOOR MODELS

ORGANICS CUT-OUT
WITH HARD LINER



M-3000 CUT-OFF FLOOR MODEL

ADDITIONAL FLOOR BRACES
REQUIRED FOR TRADESHOW
USAGE



M-1300 CUT-OFF FLOOR MODEL



CITYSCAPE CUT-OFF
FLOOR MODEL

ASSEMBLY INSTRUCTIONS: HALO

FRAME ASSEMBLY

STEP 1: Bottom Ring

- Follow the number sequence
- Start building the bottom ring by connecting one bottom ring segment at a time.

STEP 2:

- Connect the uprights to the bottom ring.

STEP 3: Upper Ring and Frame

- Follow the number sequence
- Start building the upper ring by connecting one bottom ring segment at a time.
- Connect the upper ring to the uprights.

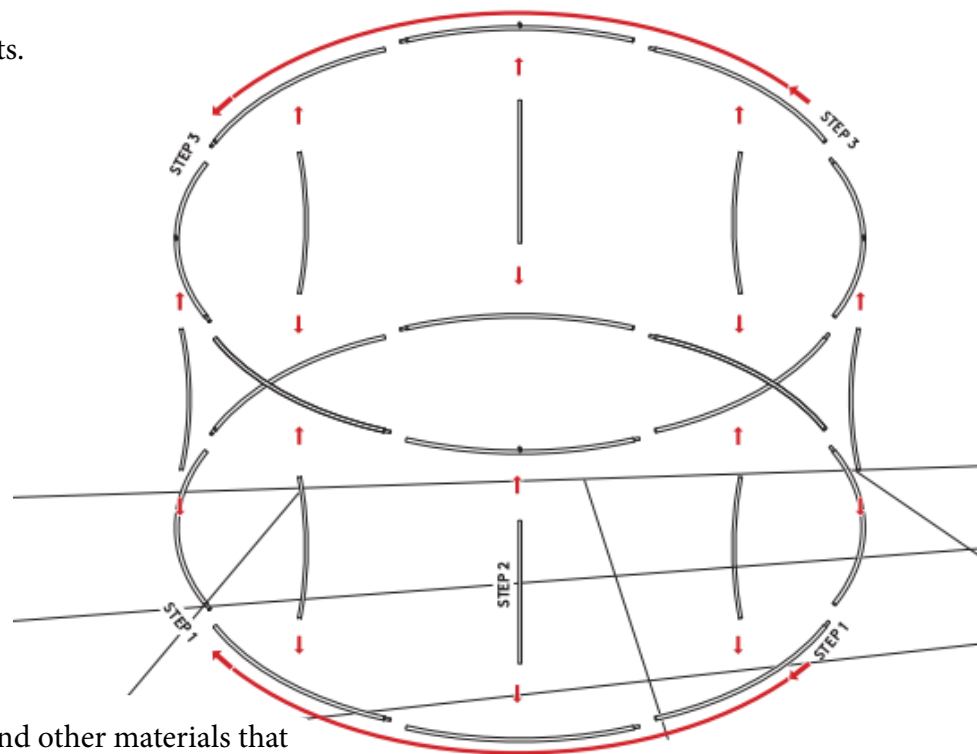

FABRIC INSTALLATION

- Make sure work area is clean of dirt and other materials that might damage or dirty the fabric. Use a drop cloth if possible and never use newsprint
- Put the unzip fabric on the floor and open up the fabric
- Put frame on top of fabric, make sure to match the button holes to the hanging points
- Pull the outside and inside fabric up and close zippers

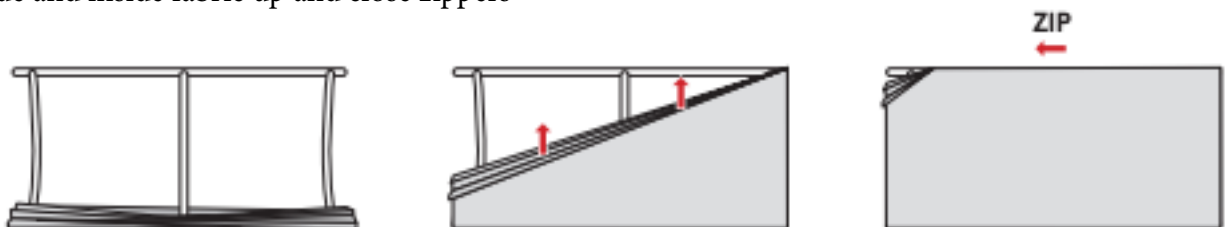

ASSEMBLY INSTRUCTIONS: 8X8 DISPLAY

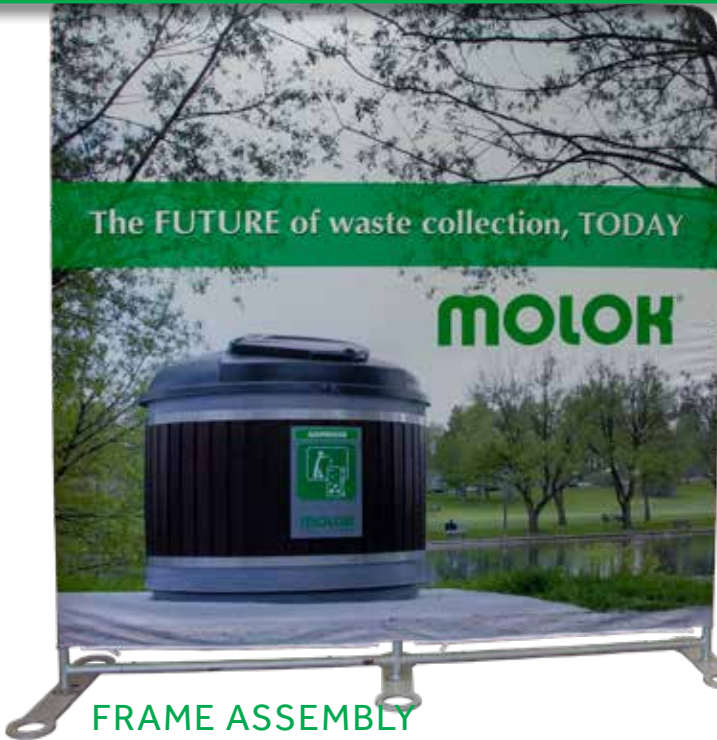

FRAME ASSEMBLY

- Follow the number sequence
- Start building the bottom first and work towards the top
- Suggested to have two people for the assembly

FABRIC INSTALLATION

- Make sure that the floor is clean. If possible use a drop cloth. Lay frame on the floor
- Locate the opening on the fabric
- Make sure that zipper is open
- Drape fabric like a pillow cover to the frame starting at the top
- Pull the fabric part way down and stand frame up
- Pull fabric completely down and close zipper

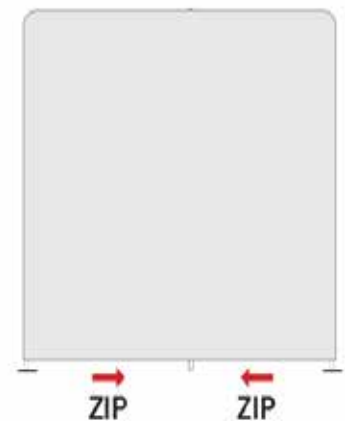
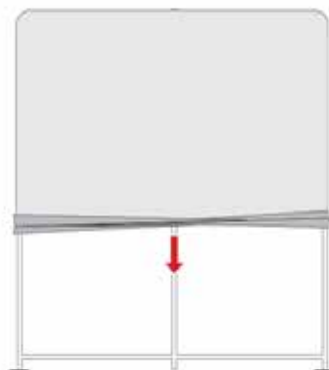

ASSEMBLY INSTRUCTIONS: VIDEO

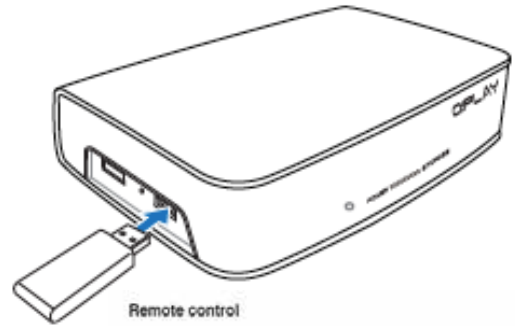

Remote control

Use the remote control to power on/off the O!PLAY HD media player, browse through menus, and select the media file to play, view, or listen to.

MONITOR SETUP

- Connect power supply to the monitor and to the O!PLAY player
- Turn each unit on, connect them via the HDMI cable included
- Follow the menu to locate the files on the inserted USB key
- Use the 'repeat' button to put the video on loop

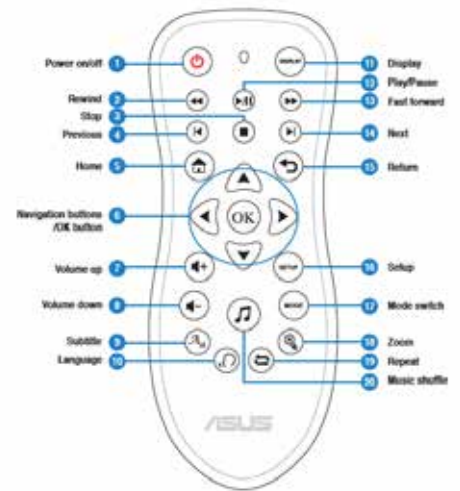
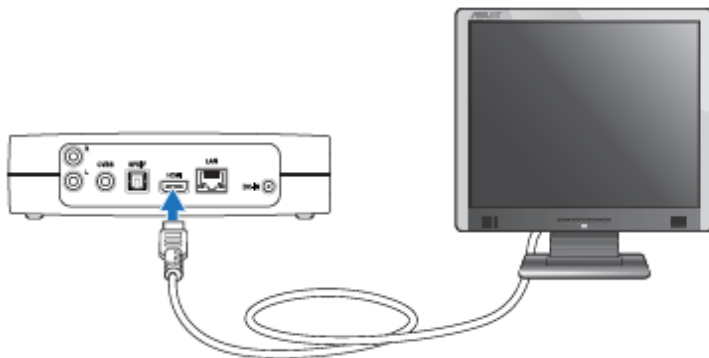
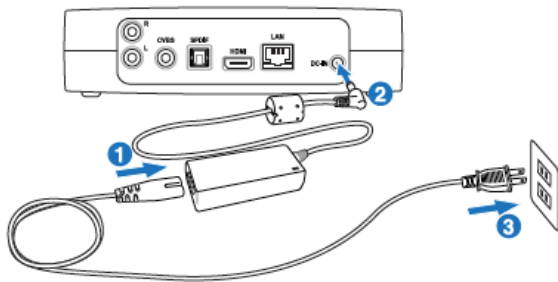

1. From the Home screen, press the up/down keys Δ / ∇ to navigate to **Movies**, then press **OK**.



2. Using the up/down keys Δ / ∇ , select the source of your video file, then press **OK**. Locate the video that you want to play.

ASSEMBLY INSTRUCTIONS: 4X6



Joints are labeled for accurate step-by-step frame assembly.



Push-button connectors make it easy to assemble.



Fabric contours to the frame for a form-fitted look.



Select displays feature a heavy-duty zipper that secures the graphic cover.

ASSEMBLY INSTRUCTIONS: COUNTER

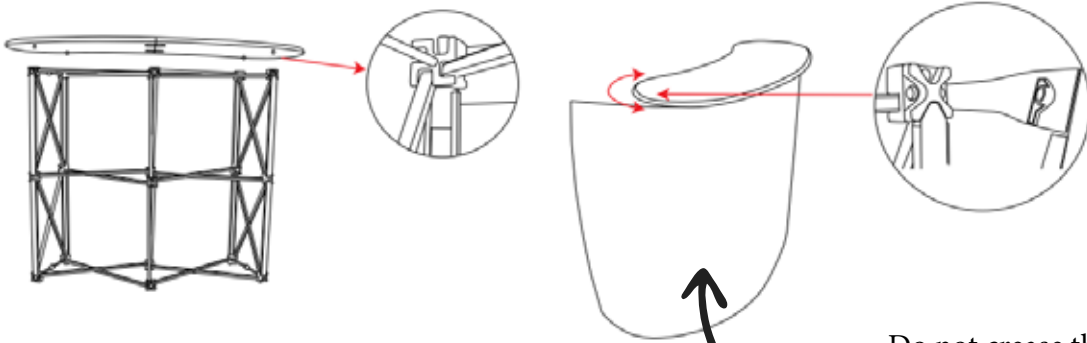
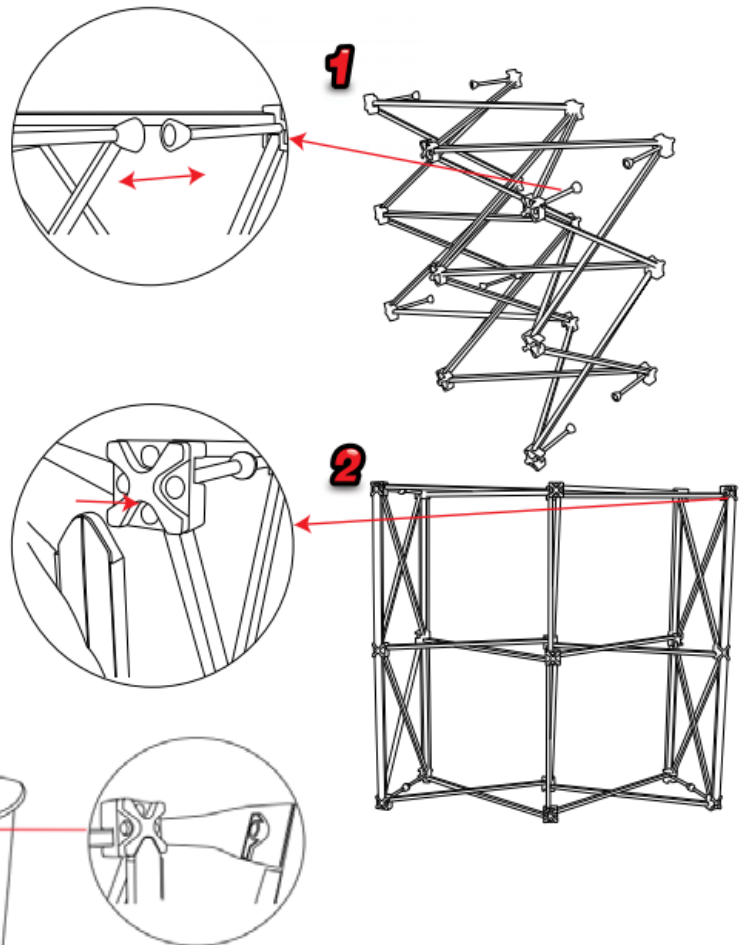

Shelf Layout

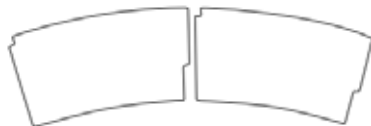

- Do not crease the outer shell and keep protected in the bubble wrap while transporting in the cylinder case

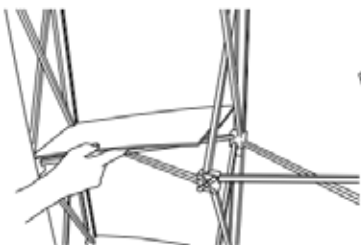

ASSEMBLY INSTRUCTIONS: PULLUP

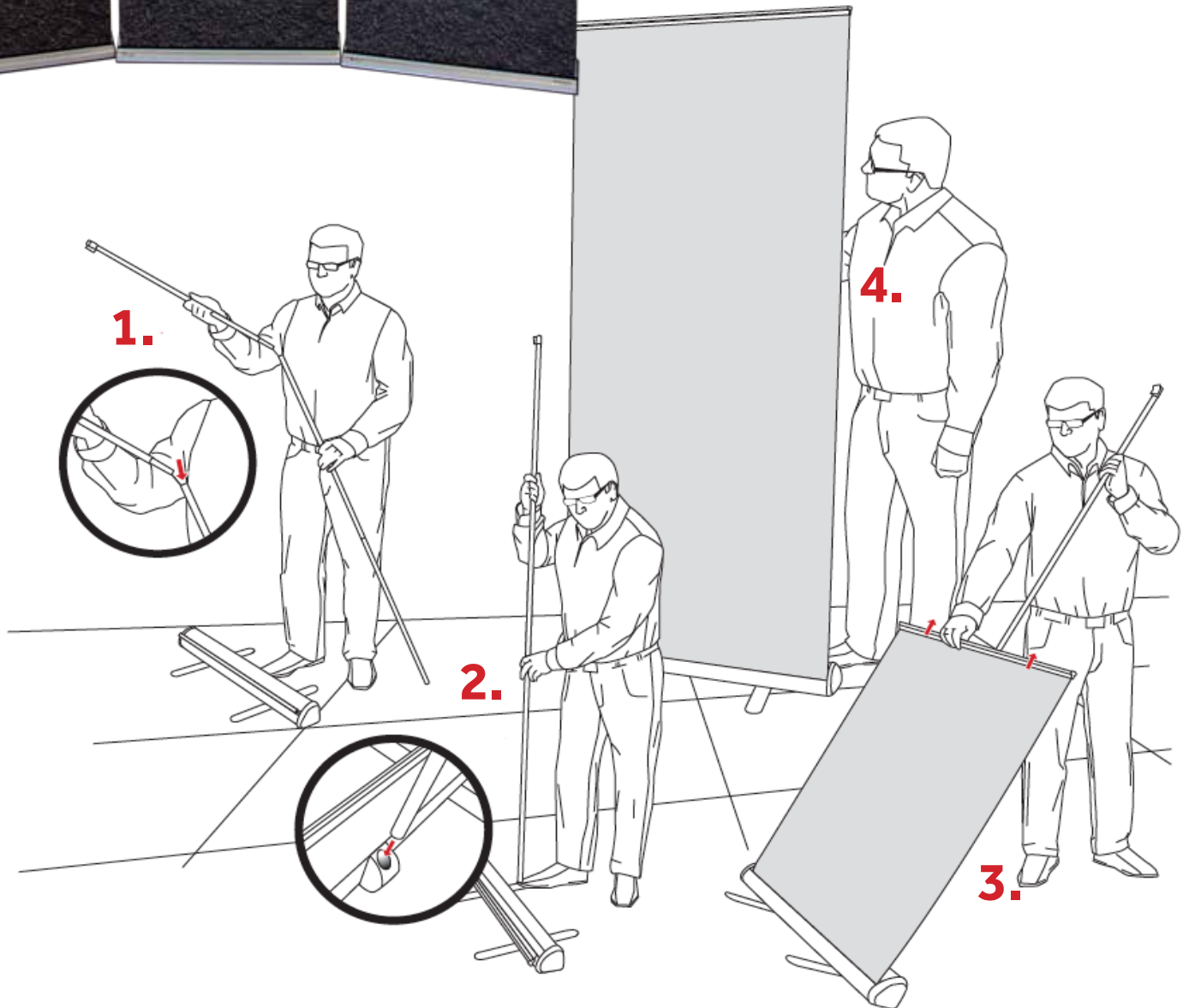

ASSEMBLY INSTRUCTIONS: POPUP

original
MOLOH[®]
by Veikko Salli



original



DISPLAY SET UP

1. Take display out of the bag.
2. Put display on the floor and expand the display.
3. Connect all the hooks together.
4. Install endcaps.

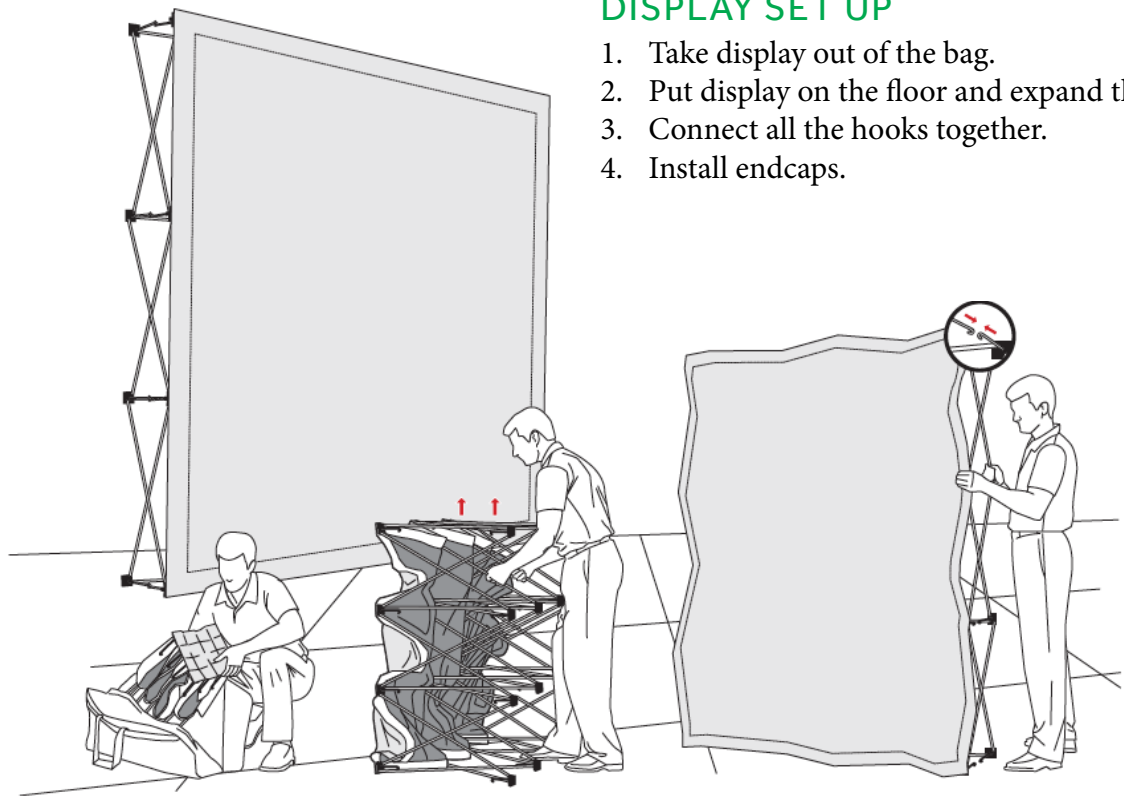

FIGURE 1

FIGURE 2

FIGURE 3

ENDCAP INSTALLATION

- Attach top corner of the endcap to the top mount
- Attach bottom corner of the endcap to the bottom mount
- Attach the side of the endcap to the side mounts
- Do the same thing on the other side

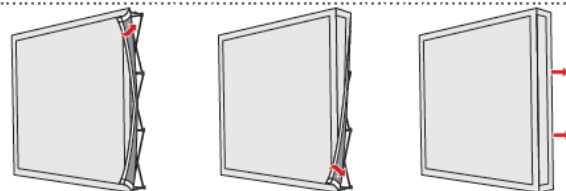

MARKETING MATERIALS - BROCHURES

MOLOK
North America Ltd.
Waste and Recycling Collection

1999-2019
20 YEARS

The
FUTURE
of waste collection,
TODAY.

MOLOK[®]
LA RÉVOLUTION
des déchets et du recyclage

MOLOK[®]
REVOLUTIONIZING
Waste and Recycling Collection
for Organics

MOLOK[®]
LA RÉVOLUTION
de la collecte
des matières résiduelles
ORGANIQUES

INTRODUCING
M-FISH

An ideal solution for parks with fishing!

- fishing patrons have a convenient location to process their catch
- can be placed anywhere: directly at the beach, grass areas or near parking
- provides an area that's easily accessible by more visitors - fishing and leisure alike
- the semi-underground design keeps contents cool inside and the external area odour-free
- results in cleaner docking and swimming areas
- waste is collected with less frequency

Another smart innovation by Molok!

MOLOK[®]
North America Ltd.

MOLOK[®]
REVOLUTIONIZING
Waste and Recycling Collection
for Parks

MOLOK[®]
LA RÉVOLUTION
Gestion des matières résiduelles
Dans les parcs et
places publiques

MOLOK[®]
North America Ltd.
REVOLUTIONIZING
Waste and Recycling Collection
for Schools

MARKETING MATERIALS - GIVEAWAYS



HOT SAUCE



TOOL KIT KEYCHAIN



POST-IT NOTES



PEN 2017



PEN 2018



PERPETUAL CALENDAR



TOTE BAG



GOLF TOWEL



BPA-FREE BOTTLE



CARPENTER PENCIL



MECHANICAL PENCIL



PEN MADE FROM RECYCLED PLASTIC